

## TUBE SPECIFICATION

**CUSTOMER:** KAMA PIGMENTS

**CUST. DESC.:** Empty Paint Tubes - 125ml

**CUST. CODE:** AC-TU0150-A

**ITEM DESC.:** 1 1/2 X 179 MM

**CUST.SPEC REF:**

**SLUG:** SL1/1/2R0070      ALUMINUM (99.7% - 1070 ALLOY)  
**SHOULDER FINISH:** PLAIN  
**NECK STYLE:** ROUND

	MINIMUM	TARGET	MAXIMUM	UM
A. TUBE DIAMETER	1.49500	1.50000	1.50500	IN
B. TUBE LENGTH	178.20000	179.00000	179.80000	MM
D. SHOULDER THICKNESS	0.02000	0.03000	0.04000	IN
C. WALL THICKNESS PLAIN	0.00500	0.00550	0.00600	IN
G. NECK I.D	0.50000	0.51000	0.52000	IN
H. NECK LENGTH	0.40500	0.41500	0.42500	IN
K. THREAD O.D	0.76000	0.76500	0.77000	IN
J. MEMBRANE THICKNESS	0.00000	0.00000	0.00000	IN
I. MEMBRANE DEPTH	0.00000	0.00000	0.00000	IN

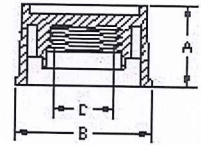

INTERNAL COATING: LQ0923	LACQU (PE1090-21)			
THICKNESS	3.00000	5.00000	6.00000	MSI

EXTERNAL COATING: PN2532	CLEAR BASECOAT ENAMEL			
THICKNESS	6.00000	7.00000	8.00000	MSI
E. PLAIN METAL	0.03125	0.06250	0.09375	IN
WALL THICK. W/COATINGS (REF)	0.00590	0.00690	0.00790	IN

CLOSURE: CP20M/1340BLK	M20 BLK LDPE SU RW			
RESIN:	PE1122B			
COLORANT:	PE-151			
A. HEIGHT	0.52100	0.53100	0.54100	IN
B. DIAMETER	0.90500	0.91500	0.92500	IN
C. THREAD I.D	0.71900	0.72400	0.72900	IN
TORQUE	2.00000	5.00000	6.00000	IN-LB

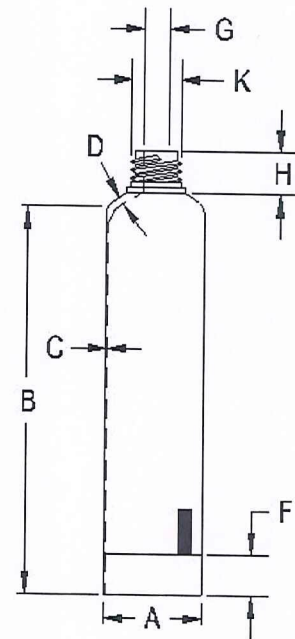

CRIMP SEALANT: CS0982	DAREX WBC2311D-63.5-1			
L. WIDTH	0.37500	0.50000	0.62500	IN
M. START-IN	0.01562	0.06250	0.12500	IN